

# Technical Specification of the PVA EXPO PRAGUE Exhibition Centre

## Plan of the PVA EXPO PRAGUE Exhibition Centre

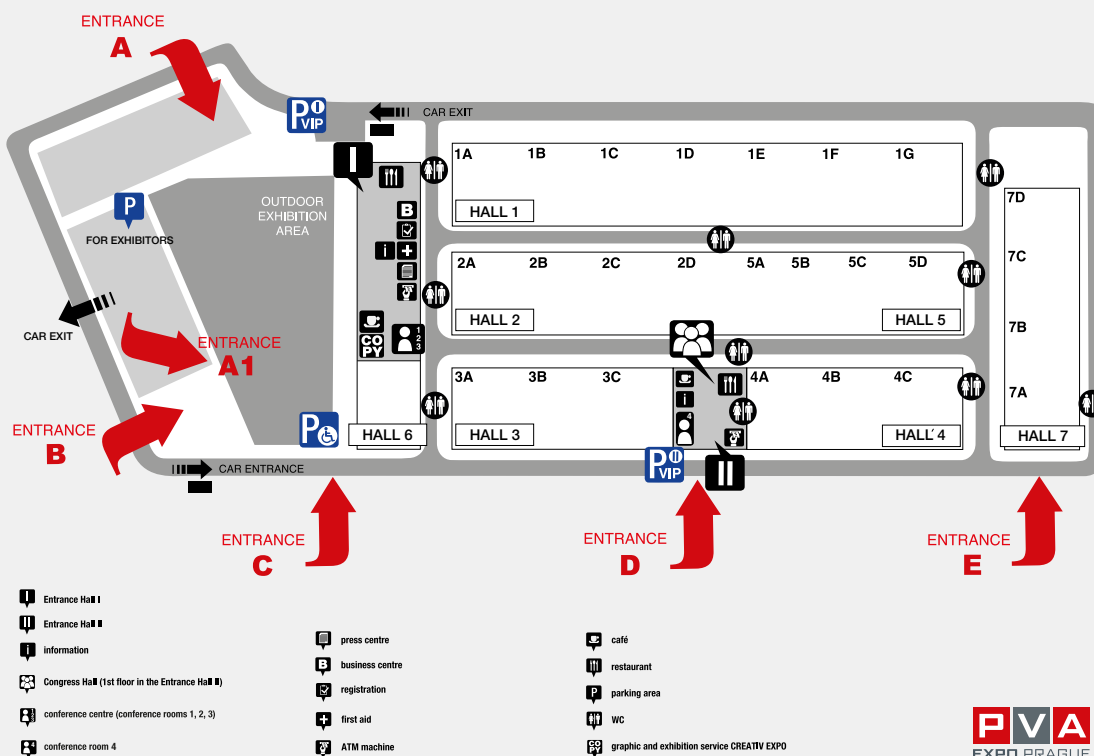

**PVA**  
EXPO PRAGUE

### Exhibition Halls at PVA EXPO PRAGUE

Building	Gross Area	The Internal Dimensions of the Hall	The Inner Side Height of the Hall	Inner Medium Height of the Hall
Entry hall I	2,700 m <sup>2</sup>	30 m x 90 m	3.5 m	7.5 m
Entry hall II	1,600 m <sup>2</sup>	40 m x 40 m	11 m	Built-in floor
Hall 1	9,840 m <sup>2</sup>	40 m x 246 m	4 m	8.5 m
Hall 2	4,000 m <sup>2</sup>	40 m x 100 m	9 m	9 m
Hall 2D	800 m <sup>2</sup>	40 m x 20 m	9 m	9 m
Hall 3	4,000 m <sup>2</sup>	40 m x 100 m	9 m	9 m
Hall 4	4,200 m <sup>2</sup>	40 m x 105 m	9 m	9 m
Hall 5	5,000 m <sup>2</sup>	40 m x 125 m	9 m	9 m
Hall 6	1,170 m <sup>2</sup>	30 m x 39 m	3.5 m	7.5 m
Hall 7	4,000 m <sup>2</sup>	40 m x 100 m	4.5 m	4.5 m



[www.pvaexpo.cz](http://www.pvaexpo.cz)

**PVA EXPO PRAGUE**  
Beranových 667,  
199 00 Prague 9,  
Czech Republic

**GPS:**  
Loc: 50°7'41.662"N,  
14°30'51.679"

page no. 1

**PVA**  
EXPO PRAGUE

A place where  
you'll get noticed

# Technical Specification of the PVA EXPO PRAGUE Exhibition Centre

## Halls

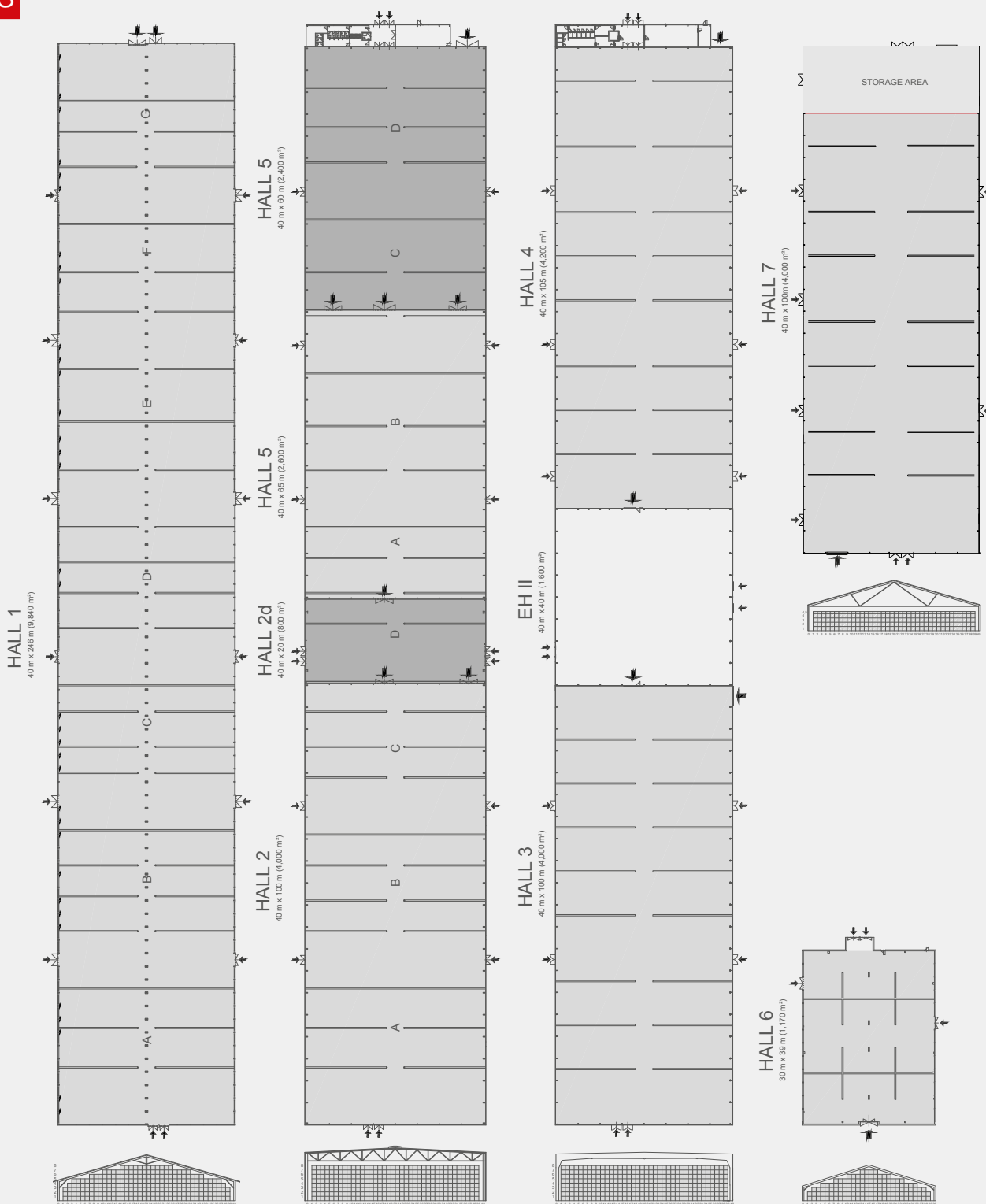

[www.pvaexpo.cz](http://www.pvaexpo.cz)

### PVA EXPO PRAGUE

Beranových 667,  
199 00 Prague 9,  
Czech Republic

### GPS:

Loc: 50°7'41.662"N,  
14°30'51.679"

page no. 2

**PVA**  
EXPO PRAGUE

A place where  
you'll get noticed

# Technical Specification of the PVA EXPO PRAGUE Exhibition Centre

## Entrance Hall I

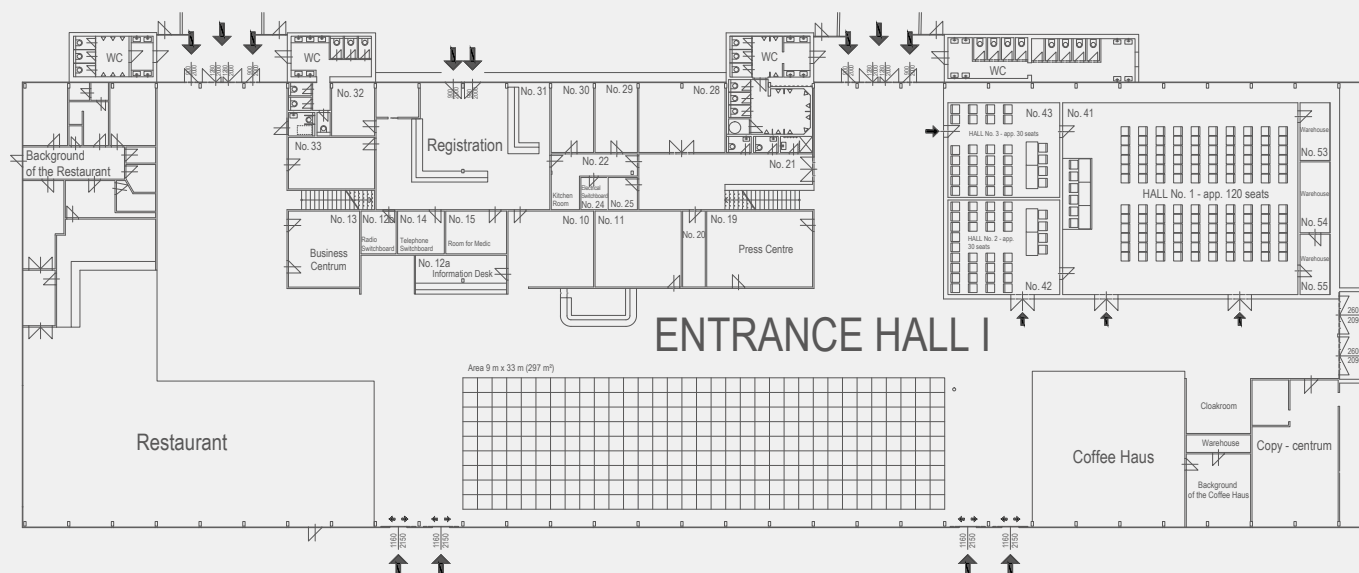

### Entry Hall I:

Gross Area:	2,700 m <sup>2</sup>
Gross Exhibition area:	300 m <sup>2</sup>
Clearance Height of the Building:	lateral 3.5 m, middle 7.5 m
Technical Driveway:	from the hall no. 6
Personnel and Visitor Entrances:	sliding and double leaf doors
Floor:	interlocking tiles, ceramic tiles
Allowable Bearing Capacity of the Floor:	800 – 1,500 kg/m <sup>2</sup> (capacity can be technologically increased, according to requirements of the exhibits)
Installation after Consultation:	connections of water, electric current, compressed air, telephone, internet
Lighting:	natural – through glass walls, artificial – fluorescent lamps
Heating:	hot water
Ventilation of Halls:	yes
Other Equipment:	fixed installation of restaurant and snack bar conference center, press center, business center cloakroom information counters floor built-in offices ATM copy center radio switchboard the insurance company emergency room



www.pvaexpo.cz

### PVA EXPO PRAGUE

Beranových 667,  
199 00 Prague 9,  
Czech Republic

### GPS:

Loc: 50°7'41.662"N,  
14°30'51.679"



A place where  
you'll get noticed

# Technical Specification of the PVA EXPO PRAGUE Exhibition Centre

## Entrance Hall II, Congress Hall

Ground Floor

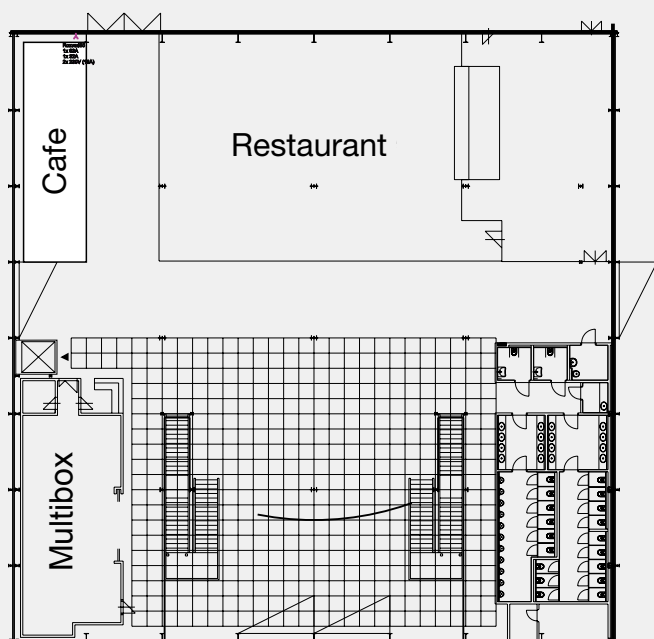

1<sup>st</sup> Floor

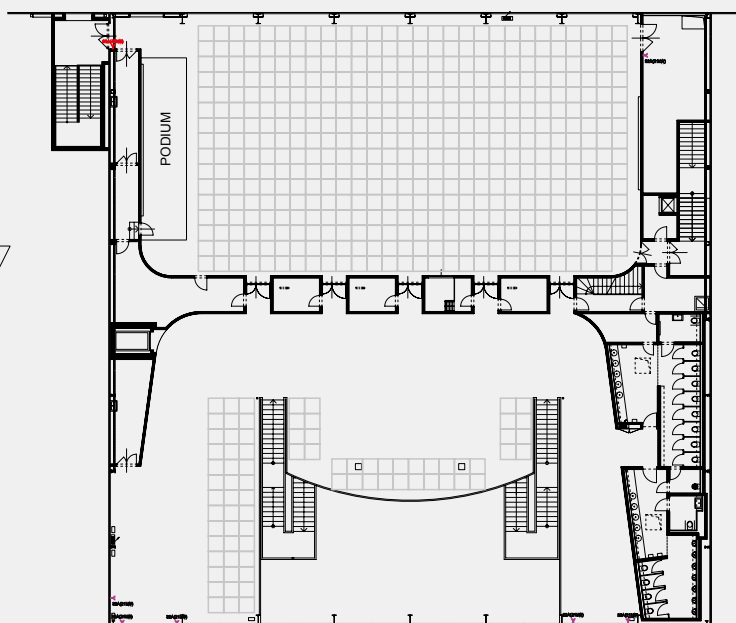

Entrance Hall II	
Gross Exhibition area:	1,600 m <sup>2</sup>
Clearance Height:	5 m
Technical Entry:	from Hall 3
Entry for Personnel and Visitors:	double leaf doors
Floor:	industrial concrete slab
Allowable Bearing Capacity of the Floor	800 – 1,500 kg/m <sup>2</sup> (capacity can be technologically increased, according to requirements of the exhibits)
Installation upon request:	connections of water, electric current, internet
Lighting:	natural light (glass walls), artificial light - fluorescent lamps
Heating:	hot-air, air-conditioning (Congress Hall)
Ventilation:	yes
Air-conditioning in the Congress Hall and Conference Room:	yes
Additional equipment:	Fixed restaurant and coffee place
	Cloakroom
	Information counter



# Technical Specification of the PVA EXPO PRAGUE Exhibition Centre

## Hall 1

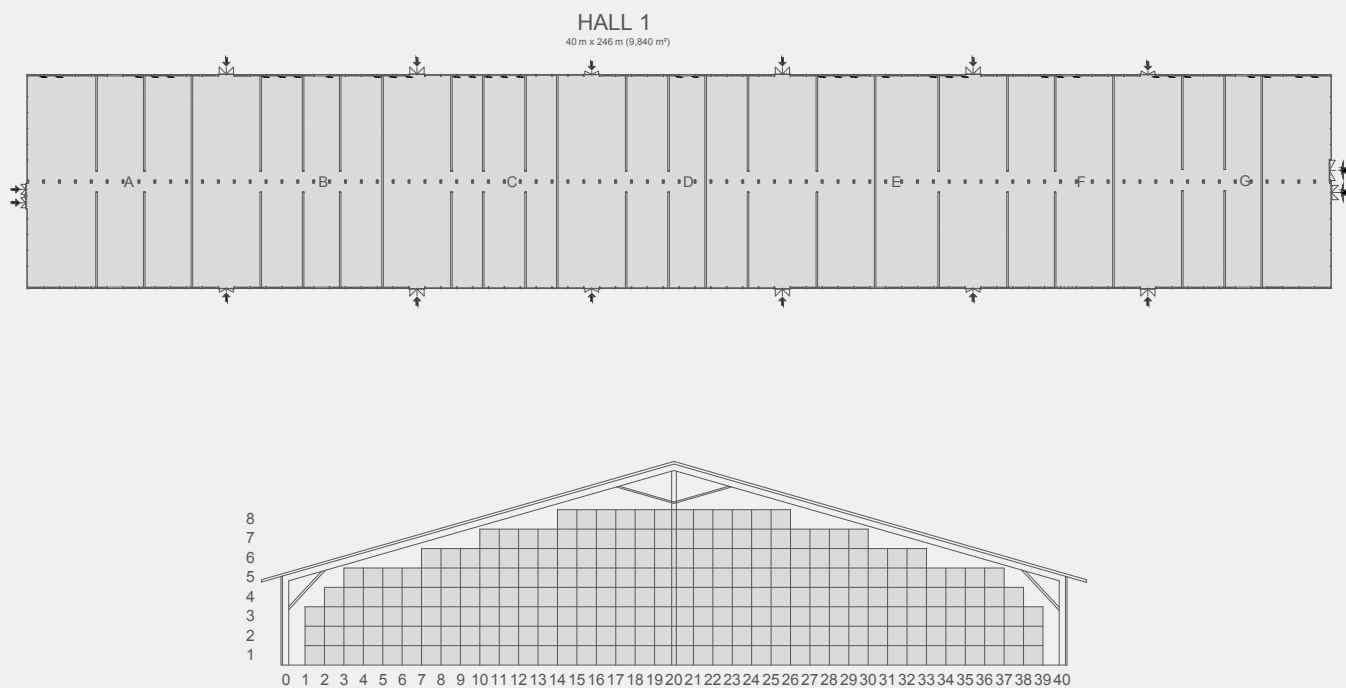

Hall 1:	
Gross Exhibition area:	9,840 m <sup>2</sup>
Clearance Height of the Building:	lateral 4 m, middle 8.5 m
Profiles of Entries:	double leaf doors, double leaf and rolling gates
Floor:	industrial polished plastic-concrete slab with gutters, the slope of 1/140 of the length of the hall
Allowable Bearing Capacity of the Floor:	800 – 1,500 kg/m <sup>2</sup> (capacity can be technologically increased, according to requirements of the exhibits)
Installation:	connections of water, electric current, compressed air, telephone, internet
Lighting:	25% natural light - windows, skylights; artificial light- fluorescent lamps
Heating:	hot-air
Ventilation:	yes



[www.pvaexpo.cz](http://www.pvaexpo.cz)

**PVA EXPO PRAGUE**  
Beranových 667,  
199 00 Prague 9,  
Czech Republic

**GPS:**  
Loc: 50°7'41.662"N,  
14°30'51.679"

**PVA**  
EXPO PRAGUE

A place where  
you'll get noticed

# Technical Specification of the PVA EXPO PRAGUE Exhibition Centre

## Hall 2 / Hall 2D / Hall 5

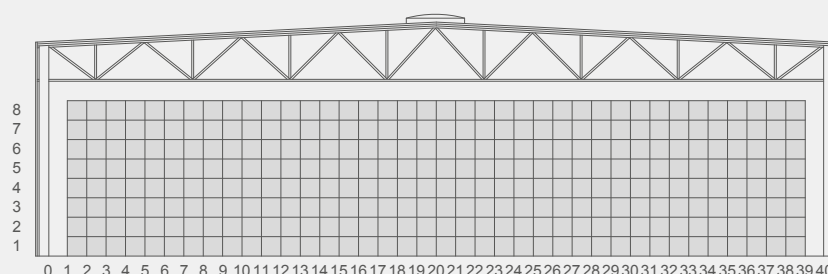
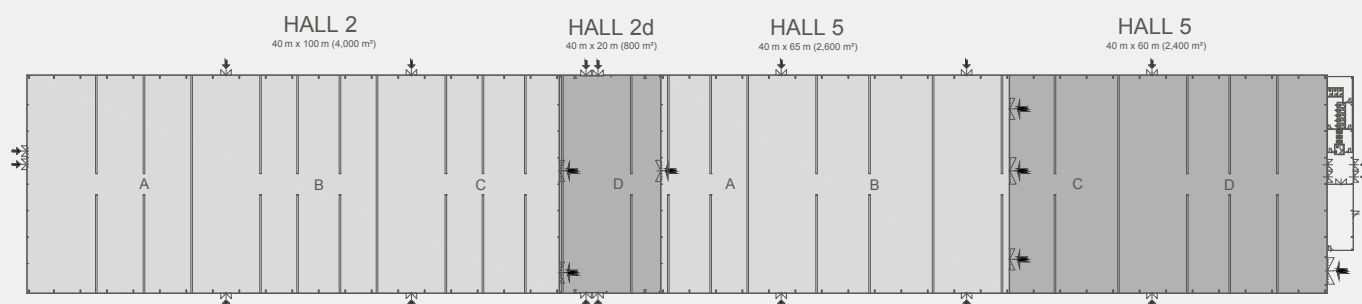

Hall 2 / Hall 2D / Hall 5:	
Gross Exhibition Area:	Hall 2: 4,000 m <sup>2</sup> Hall 2D: 800 m <sup>2</sup> Hall 5: 5,000 m <sup>2</sup> (divided into sectors AB 40 m x 65 m and CD 40 m x 60 m)
Clearance Height of the Building:	8.5 m across the entire width
Profiles of Entries:	double leaf doors and rolling gate
Floor:	industrial polished plastic-concrete slab with gutters, the slope of 1/140 of the length of the hall
Allowable Bearing Capacity of the Floor:	800 – 1,500 kg/m <sup>2</sup> (capacity can be technologically increased, according to requirements of the exhibits)
Installation:	connections of water, electric current, compressed air, telephone, internet
Lighting:	Hall 2: 20% natural light - ceiling skylights; artificial light - fluorescent light
	Hall 2D: 35% natural light - ceiling skylights; artificial light - fluorescent light
	Hall 5: 20% natural light - ceiling skylights; artificial light - fluorescent light
Heating:	hot-air
Ventilation:	yes



[www.pvaexpo.cz](http://www.pvaexpo.cz)

**PVA EXPO PRAGUE**  
 Beranových 667,  
 199 00 Prague 9,  
 Czech Republic

**GPS:**  
 Loc: 50°7'41.662"N,  
 14°30'51.679"

**PVA**  
 EXPO PRAGUE

A place where  
 you'll get noticed

# Technical Specification of the PVA EXPO PRAGUE Exhibition Centre

## Hall 3 / Hall 4

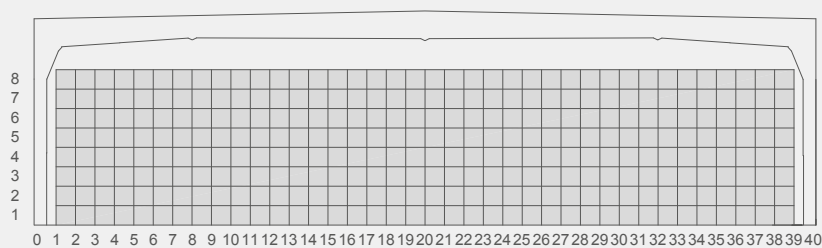
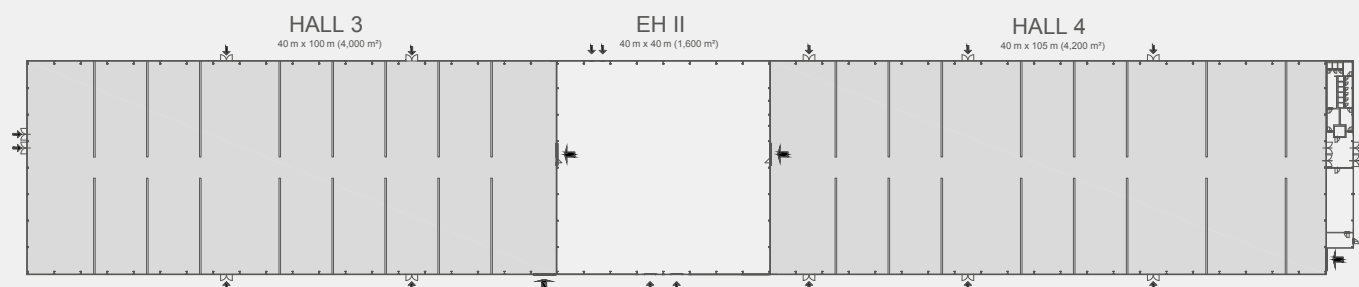

Hall 3 and Hall 4:	
Gross Exhibition area:	4,000 m <sup>2</sup> + 4,200 m <sup>2</sup>
Clearance Height of the Building:	8.5 m across the entire width
Profiles of Entries:	double leaf doors and rolling gate
Floor:	industrial with gently structural COMFLOOR surface, with gutters; the slope of 1/140 of the length of the hall
Allowable Bearing Capacity of the Floor:	1,500 kg/m <sup>2</sup> (capacity can be technologically increased, according to requirements of the exhibits)
Installation:	connections of water, electric current, compressed air, telephone, internet
Lighting:	20% natural light - ceiling skylights; artificial light - fluorescent light
Heating:	hot air gas heating
Ventilation:	yes



[www.pvaexpo.cz](http://www.pvaexpo.cz)

**PVA EXPO PRAGUE**  
Beranových 667,  
199 00 Prague 9,  
Czech Republic

**GPS:**  
Loc: 50°7'41.662"N,  
14°30'51.679"

**PVA**  
EXPO PRAGUE

A place where  
you'll get noticed

page no. 7

# Technical Specification of the PVA EXPO PRAGUE Exhibition Centre

## Hall 6

### HALL 6

30 m x 39 m (1,170 m<sup>2</sup>)

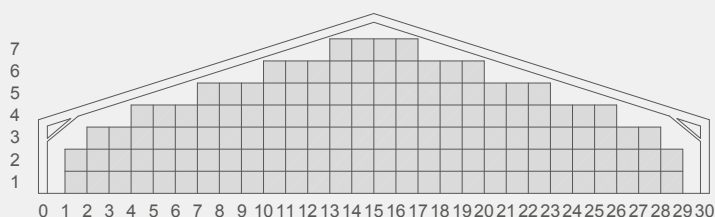
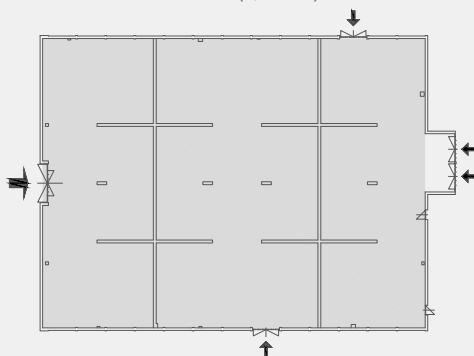

#### Hall 6:

Total Gross Area:	1,170 m <sup>2</sup>
Clearance Height of the Building:	lateral 3.5 m, middle 7 m
Profiles of Entries:	double leaf doors and rolling gate
Floor:	industrial polished plastic-concrete slab with the gutters, the slope of 1/140 of the length of the hall
Allowable Bearing Capacity of the Floor:	800 – 1,500 kg/m <sup>2</sup> (capacity can be technologically increased, according to requirements of the exhibits)
Installation:	connections of water, electric current, compressed air, telephone, internet
Lighting:	20% natural light - ceiling skylights; artificial light- fluorescent lamps
Heating:	hot air
Ventilation:	yes



[www.pvaexpo.cz](http://www.pvaexpo.cz)

**PVA EXPO PRAGUE**  
Beranových 667,  
199 00 Prague 9,  
Czech Republic

**GPS:**  
Loc: 50°7'41.662"N,  
14°30'51.679"

page no. 8

**PVA**  
EXPO PRAGUE

A place where  
you'll get noticed



# Technical Specification of the PVA EXPO PRAGUE Exhibition Centre

## Hall 7

### HALL 7

40 m x 100 m (4 000 m<sup>2</sup>)

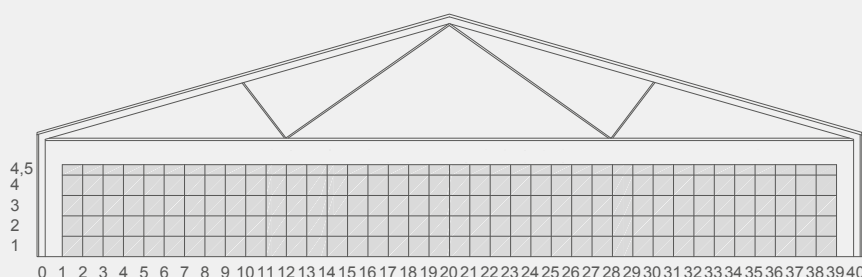
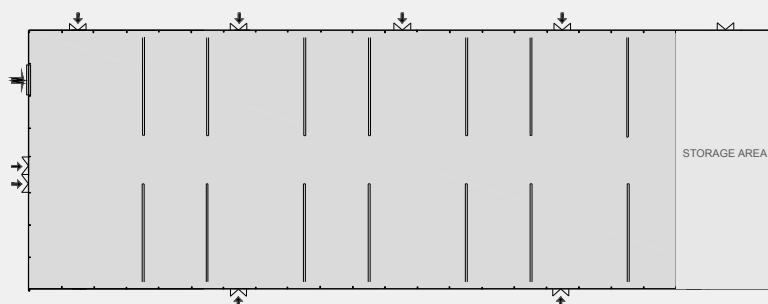

#### Hall 7:

Total Gross Area:	4,000 m <sup>2</sup>
Clearance Height of the Building:	4.5 m
Profiles of Entries:	double leaf doors and rolling gates (2)
Floor:	industrial polished plastic-concrete slab with gutters
Allowable Bearing Capacity of the Floor:	800 – 1,500 kg/m <sup>2</sup> (capacity can be technologically increased, according to requirements of the exhibits)
Installation:	connections of water, electric current, compressed air, telephone, internet
Lighting:	25% natural light - ceiling skylights; artificial light- fluorescent lamps
Heating:	hot air
Ventilation:	yes



[www.pvaexpo.cz](http://www.pvaexpo.cz)

#### PVA EXPO PRAGUE

Beranových 667,  
199 00 Prague 9,  
Czech Republic

#### GPS:

Loc: 50°7'41.662"N,  
14°30'51.679"



A place where  
you'll get noticed

# Technical Specification of the PVA EXPO PRAGUE Exhibition Centre

## Outdoor Area in PVA EXPO PRAGUE

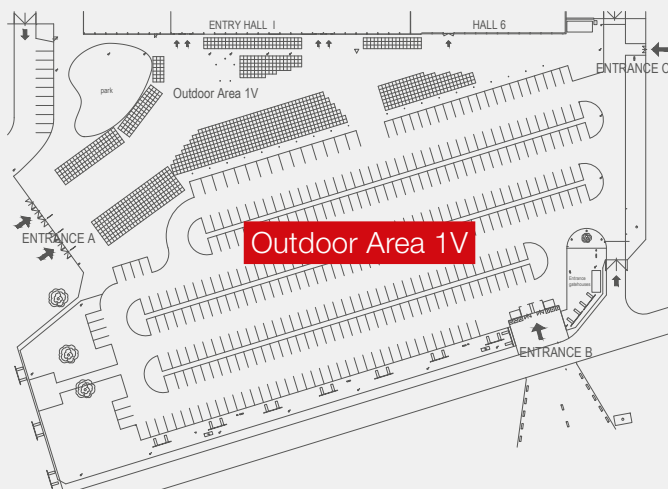

Outdoor Area 1V:	
Total Gross Area:	3,000 m <sup>2</sup>
The Area Surface:	interlocking tiles
Installation after Consultation:	connection of electric power, water connection – except from the winter season, compressed air - mobile compressors
Lighting:	lighting around the perimeter of the area

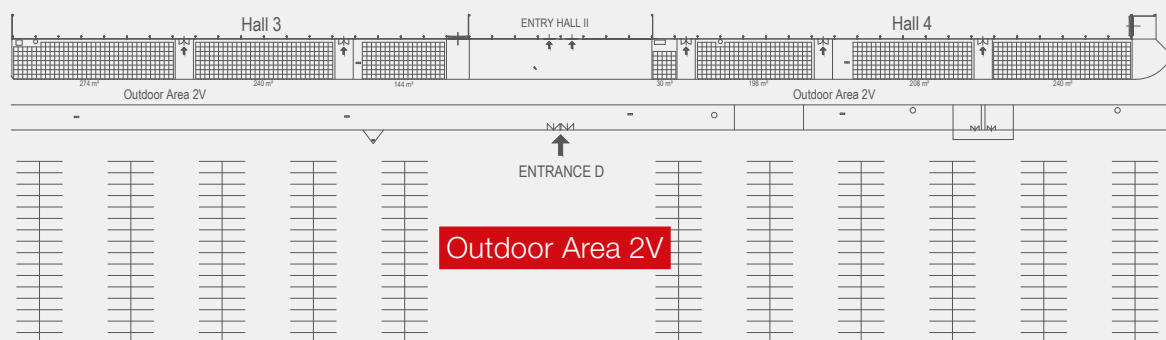

Outdoor Area 2V:	
Total Gross Area:	1,330 m <sup>2</sup>
The Area Surface:	interlocking tiles
Installation after Consultation:	connection of electric power, water connection – except from the winter season, compressed air - mobile compressors
Lighting:	lighting around the perimeter of the area



# Technical Specification of the PVA EXPO PRAGUE Exhibition Centre

## Conference Rooms in PVA EXPO PRAGUE

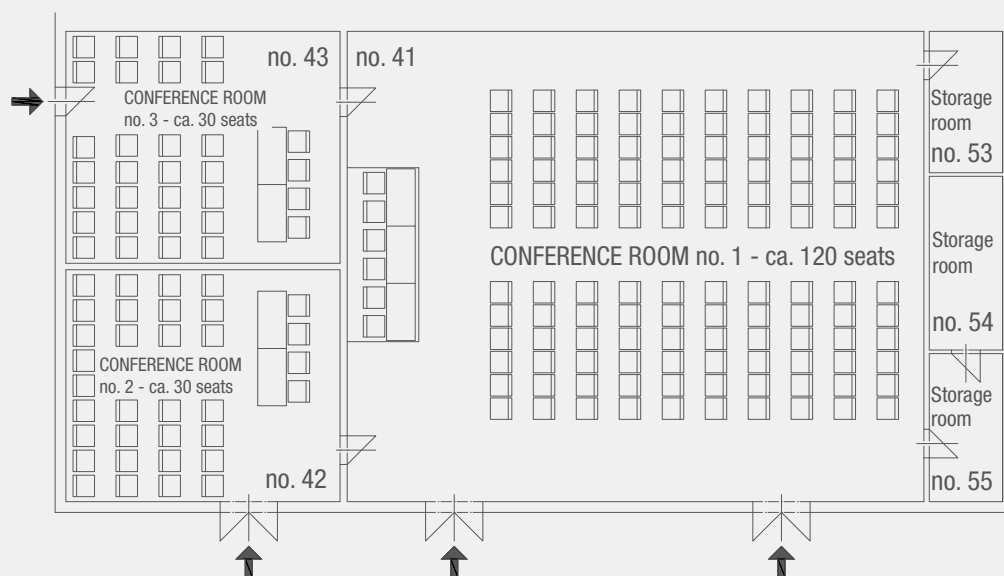

### Conference Room 1

Conference Room 1:	
Total Area:	208 m <sup>2</sup> (16 x 13 m)
The Area Surface:	carpet
Installation:	connections of electricity (230 V), internet
Equipment:	podium, lecture stand, chairs, screen, data projector, AV equipment

### Conference Rooms 2 and 3

Conference Rooms 2 and 3:	
Total Area:	48 m <sup>2</sup> (7,5 x 6,4 m)
The Area Surface:	PVC
Instalace:	connections of electricity (230 V), internet
Equipment:	tables, chairs

